

Manway Cover Detail

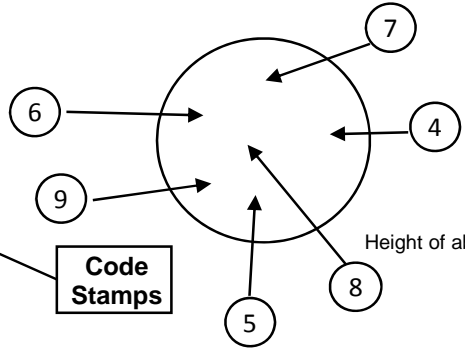

Outside Dia	25"
No of bolts:	16
Bolt length:	7"
Bolt dia.:	1-1/8"
Nom. size:	18"
Rating:	150#
Type:	Long Neck
Height of above shell:	23"

Inches from Head Seam

U-1 on hand YES
Heat Treat YES
X-Ray FULL

Tank Openings

Tank Details

Description

Dimensions

O/A Length	A -	50' 0-1/2"
Length - weld to weld	B -	44' 6-1/2"
	C -	10' 5-1/2"
Weld to End	D -	33"
Width of Piers	E -	16"
C/C of Piers	F -	39' 10"
C/L of Piers to Weld end	G -	14-1/2"
	H -	42"

No	Size	Type	Description	Tank Details		Description		Dimensions
1	2"	NPT	6	Liquid	Manufacturer:	Am. Car & Foundry	Type of Head	Elliptical
2	3"	300#	18	Liquid	Date of manufacture	1956		
3	1"	NPT					Tank Capacity	USWG
4	3"	300#	M/W	Pressure Relief	Working Pressure	250	Tank Weight	estimated
5	1-1/4"	NPT	M/W		National Board Number	4519	Tank Shell	15/16"
6	1-1/4"	NPT	M/W		Serial Number	ST-14-850-2	Tank Head	15/16"
7	1-1/4"	NPT	M/W		Steel Type:	SA-212 Gr. B		
8	3/4"	NPT	M/W				Pier Type (Concrete / saddles / Flat)	Flat
9	3/4"	NPT	M/W		Jurisdiction #		Tank Saddles	Welded Steel
10	6"	300#	89	Vapor	Pressure Gauge	Yes		
11	18"	150#	56	Manway	Liquid Level Gauge	Slip Tube		
12								
13					Paint Condition:	Poor		
14					Color:	White		
15					Relief Valve Type	Consolidated	Information taken by:	Tracy Gates
16						1906LC-1	Date:	
17					Test Date		Tank Location	#2 Aberdeen, MS

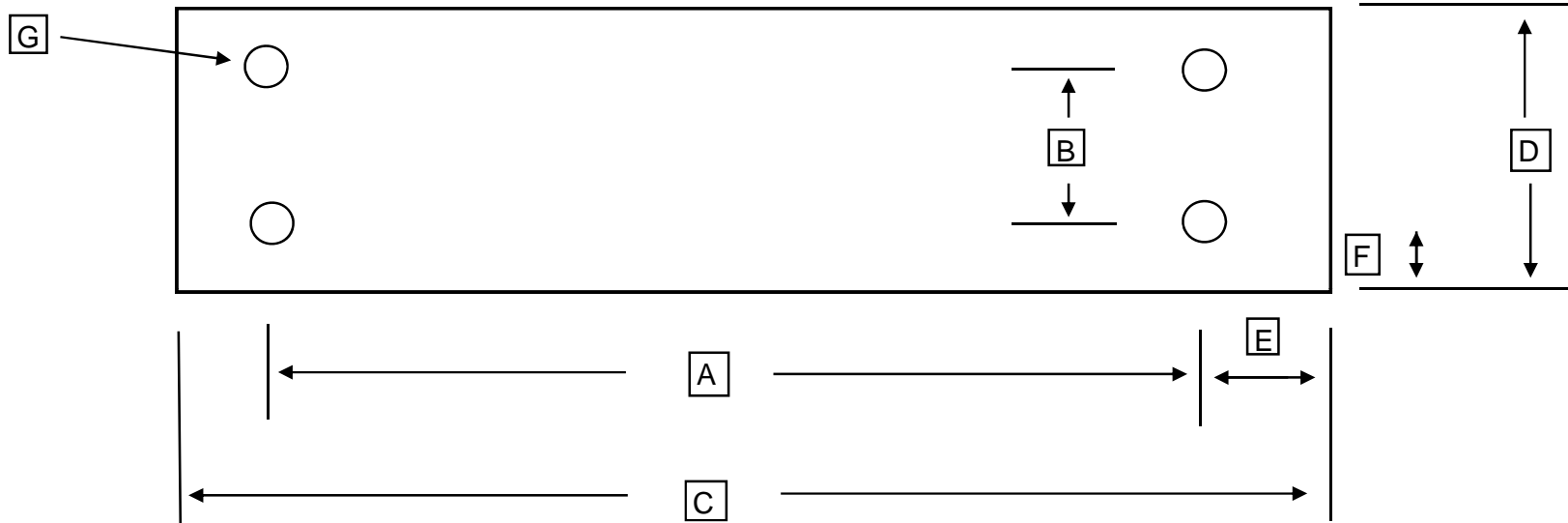

		Number of bolt holes	4
A		Center to center of bolt holes	8' 0"
B		Center to center of bolt holes	7"
C		Outside plate dimension	9' 0"
D		Outside plate dimension	10"
E		Center of hole to edge of plate	6"
F		Center of hole to edge of plate	2"
G		Bolt Hole Diameter	1"
		Bottom of Foot Plate to Shell	4"