

Manway Cover Detail

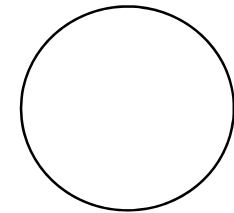

Outside Dia	25"
No of bolts:	16
Bolt length:	7"
Bolt dia.:	1-1/4"
Nom. size:	18"
Rating:	150#
Type:	Long neck
Height of above shell:	18"

Inches from Head Seam

U-1 on hand YES
Heat Treat NO
X-Ray COMPLETE

Tank Openings

Tank Details

Description	Dimensions
O/A Length	A - 92'
Length - weld to weld	B - 80' 1-1/2"
	C - 12' 1-1/2"
Weld to End	D - 6' 0"
Width of Piers	E - 12"
C/C of Piers	F - 60' 0"
C/L of Piers to Weld end	G - 10' 1-1/2"
	H - 10' 0"

No	Size	Type	Description	Tank Details		Description		Dimensions	
1	3"	150#	18	Manufacturer:	AMF Beaird	Type of Head			Hemi
2	6"	150#	30-1/2	Date of manufacture	1972				
3	3"	150#	55			Tank Capacity	USWG		74,341
4	3"	150#	44	Working Pressure	150	Tank Weight	estimated		120,000
5	3"	150#	18	National Board Number	87141	Tank Shell			3/4"
6	1/2"	150#	30	Serial Number	193219-01-2	Tank Head			1/2"
7	1"	150#	81-1/2	Steel Type:	SA-515 Grade 70				
8	3"	150#	90-1/2			Pier Type (Concrete / saddles / Flat)			Flat
9	3"	150#	102-1/2			Tank Saddles			Welded steel
10	18"	150#	157-1/2	Manway	Pressure Gauge	NO			
11	4"	Cap	217-1/2		Liquid Level Gauge	NO			
12									
13				Paint Condition:	Good				
14				Color:	White				
15						Information taken by:			Gene Botts
16				Relief Valve Type	NONE	Date:			9/4/2008
17				Test Date		Tank Location			#3 Castlegar

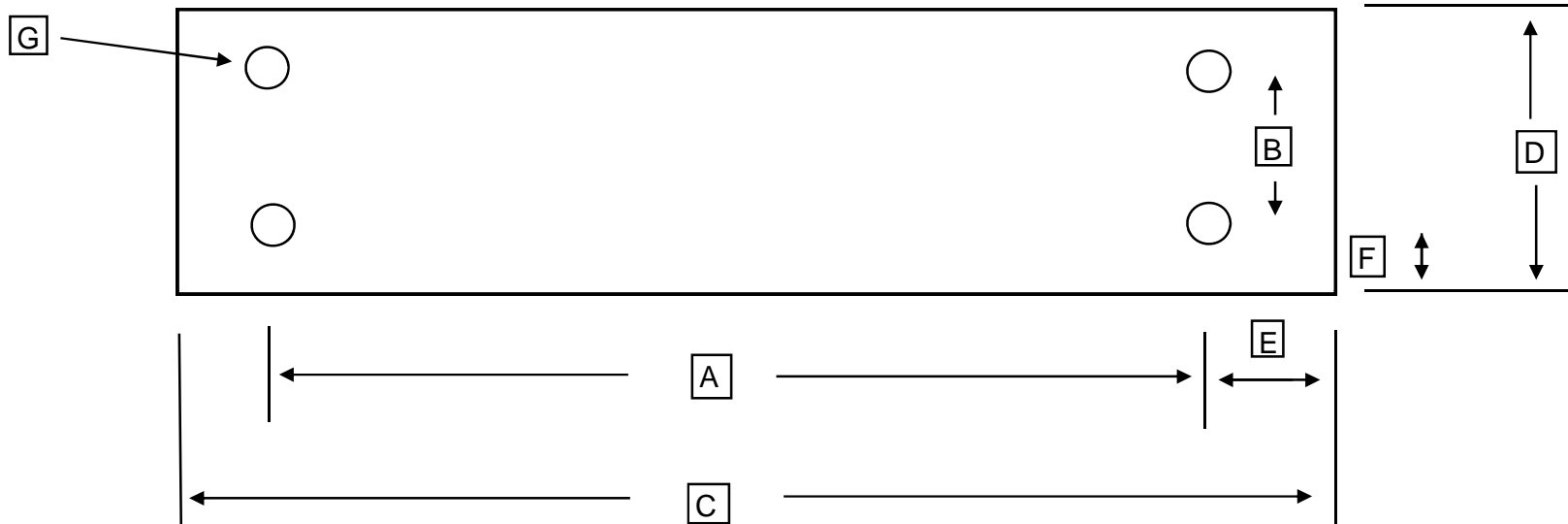

		Number of bolt holes	28
A		Center to center of bolt holes	11' 4"
B		Center to center of bolt holes	6"
C		Outside plate dimension	12' 2"
D		Outside plate dimension	12"
E		Center of hole to edge of plate	5"
F		Center of hole to edge of plate	3"
G		Bolt Hole Diameter	1-1/4"
		Bottom of Foot Plate to Shell	