

**Manway Cover Detail**

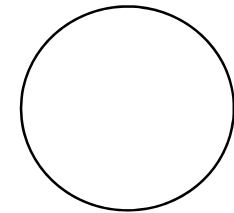

Outside Dia	25"
No of bolts:	16
Bolt length:	7"
Bolt dia.:	1-1/4"
Nom. size:	18"
Rating:	150#
Type:	Long neck
Height of above shell:	18"

Code Plate

Inches from Head Seam

U-1 on hand YES  
Heat Treat NO  
X-Ray COMPLETE

**Tank Openings**

**Tank Details**

Description		Dimensions	
O/A Length	A -		92'
Length - weld to weld	B -		80' 1-1/2"
	C -	O. D.	12' 1-1/2"
Weld to End	D -		6' 0"
Width of Piers	E -		12"
C/C of Piers	F -		60' 0"
C/L of Piers to Weld end	G -		10' 1-1/2"
	H -		10' 0"

No	Size	Type	Description	Tank Details		Description		Dimensions	
1	3"	150#	18	Manufacturer:	AMF Beaird	Type of Head			Hemi
2	6"	150#	30-1/2	Date of manufacture	1972				
3	3"	150#	55			Tank Capacity	USWG		74,341
4	3"	150#	44	Working Pressure	150	Tank Weight	estimated		120,000
5	3"	150#	18	National Board Number	87145	Tank Shell			3/4"
6	1/2"	150#	30	Serial Number	193219-01-6	Tank Head			1/2"
7	1"	150#	81-1/2	Steel Type:	SA-515 Grade 70				
8	3"	150#	90-1/2			Pier Type (Concrete / saddles / Flat)			Flat
9	3"	150#	102-1/2			Tank Saddles			Welded steel
10	18"	150#	157-1/2	Manway	Pressure Gauge	NO			
11	4"	Cap	217-1/2		Liquid Level Gauge	NO			
12									
13				Paint Condition:	Good				
14				Color:	White				
15						Information taken by:			Gene Botts
16				Relief Valve Type	NONE	Date:			9/4/2008
17				Test Date		Tank Location			#7 Castlegar

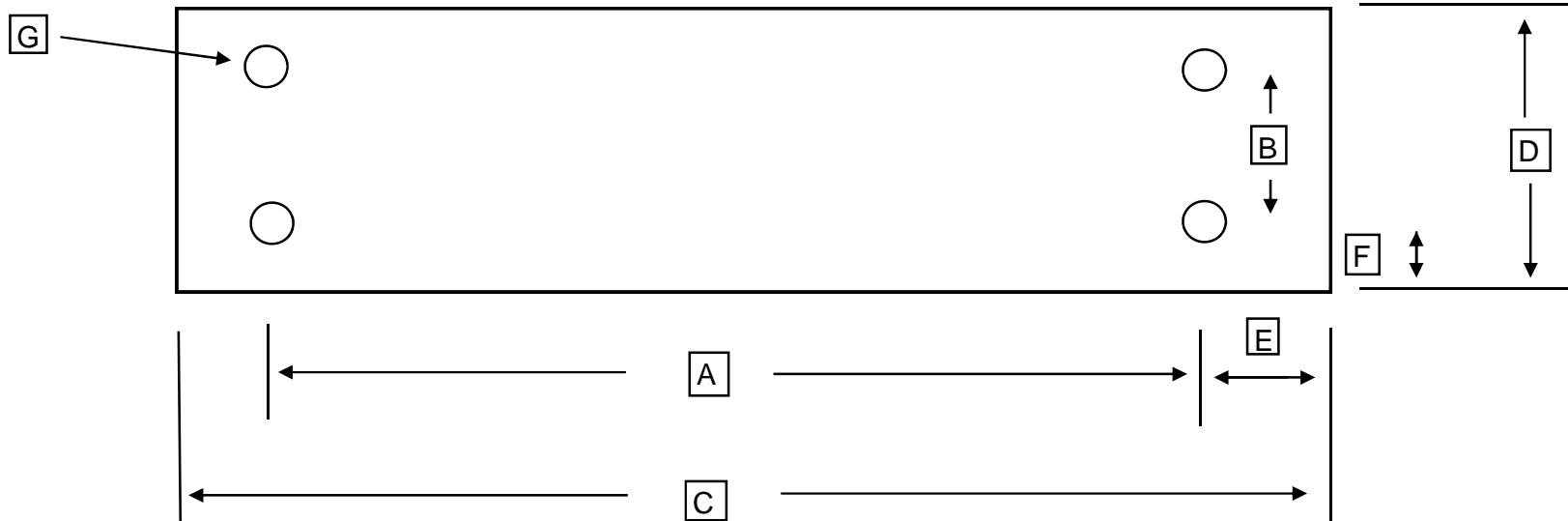

		Number of bolt holes	<b>28</b>
A		Center to center of bolt holes	<b>11' 4"</b>
B		Center to center of bolt holes	<b>6"</b>
C		Outside plate dimension	<b>12' 2"</b>
D		Outside plate dimension	<b>12"</b>
E		Center of hole to edge of plate	<b>5"</b>
F		Center of hole to edge of plate	<b>3"</b>
G		Bolt Hole Diameter	<b>1-1/4"</b>
		Bottom of Foot Plate to Shell	