

**Manway Cover Detail**

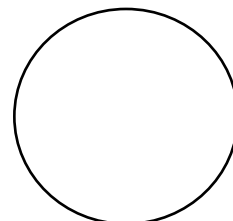

Outside Dia	
No of bolts:	
Bolt length:	
Bolt dia.:	
Nom. size:	
Rating:	
Type:	

Inches from Head Seam

Code Plate

U-1 on hand      Y/N  
 Heat Treat      Y/N  
 X-Ray              Y/N

**Tank Openings**

**Tank Details**

Description	Dimensions
O/A Length	A - 46.9'
Length - weld to weld	B - 36'
	C - 131.875"
Weld to End	D - 5' 4.5"
Width of Piers	E - 12"
C/C of Piers	F - 23' 5"
C/L of Piers to Weld end	G - 6' 7"
	H - 91 1/2"

No	Size	Type	Description	Manufacturer:	Riley Beard	Type of Head	Hemi
1	3"	Liq	Flange 12" C/L to head weld				
2	3"	Liq	Flange 32" C/L to head weld	Date of manufacture	Jun-74		
3	2"	Vap	Flange 50" C/L to head weld			Tank Capacity	USWG 29,835
4				Working Pressure	250 @ 100	Tank Weight	estimated 48,100
5				National Board Number	32510	Tank Shell	0.8125
6				Serial Number	109951-01-2	Tank Head	0.46875
7				Steel Type:			
8						Pier Type (Concrete / saddles / Flat)	Concrete
9				Jurisdiction #		Tank Saddles	N/A
10				Pressure Gauge	yes		
11				Liquid Level Gauge	Magnetel & Rotogauge		
12							
13				Paint Condition:	Average		
14				Color:	white		
15						Information taken by:	Buddy Souto
16				Relief Valve Type	multiport	Date:	7/13/2009
17				Test Date		Tank Location	Americus, Ga.

Steel Saddle Footprint Sketch

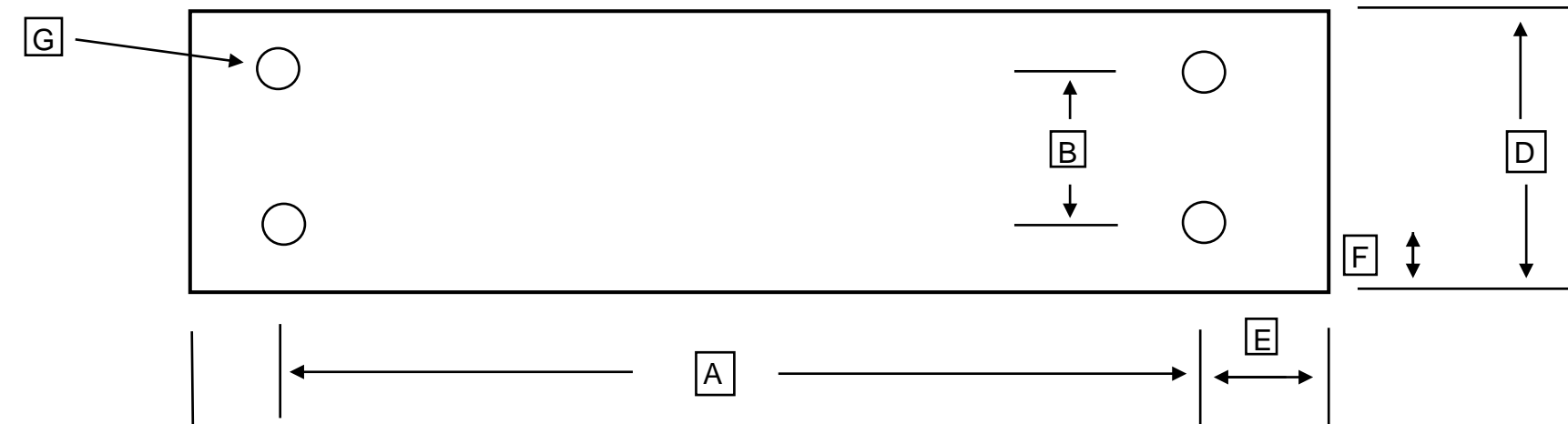

	Number of bolt holes	n/a
A	Center to center of bolt holes	n/a
B	Center to center of bolt holes	n/a
C	Outside plate dimension	n/a
D	Outside plate dimension	n/a
E	Center of hole to edge of plate	n/a
F	Center of hole to edge of plate	n/a
G	Bolt Hole Diameter	n/a
	Bottom of Foot Plate to Shell	n/a