

Manway Cover Detail

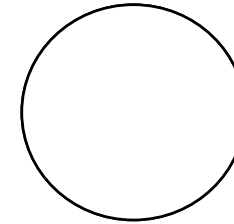

Outside Dia	
No of bolts:	
Bolt length:	
Bolt dia.:	
Nom. size:	
Rating:	
Type:	

Inches from Head Seam

Code Plate

U-1 on hand Y/N
 Heat Treat Y/N
 X-Ray Y/N

Tank Openings

Tank Details

Description	Dimensions
O/A Length	A - 46.9'
Length - weld to weld	B - 36'
O. D.	C - 131.875"
Weld to End	D - 5' 4.5"
Width of Piers	E - 12"
C/C of Piers	F - 23' 5"
C/L of Piers to Weld end	G - 6' 7"
	H - 91 1/2"

No	Size	Type	Description	Tank Details		Description		Dimensions	
1	3"	Liq	Flange	12" C/L to head weld	Manufacturer:	Riley Beard	Type of Head	Hemi	
2	3"	Liq	Flange	32" C/L to head weld	Date of manufacture	Jul-74			
3	2"	Vap	Flange	50" C/L to head weld			Tank Capacity	USWG	29,835
4					Working Pressure	250 @ 100	Tank Weight	estimated	48,100
5					National Board Number	32519	Tank Shell		0.8125
6					Serial Number	109951-01-3	Tank Head		0.46875
7					Steel Type:				
8							Pier Type	(Concrete / saddles / Flat) Concrete	
9					Jurisdiction #		Tank Saddles	N/A	
10					Pressure Gauge	yes			
11					Liquid Level Gauge	Magnetel & Rotogauge			
12									
13					Paint Condition:	Average			
14					Color:	white			
15							Information taken by:	Buddy Souto	
16					Relief Valve Type	multiport	Date:	7/13/2009	
17					Test Date		Tank Location	Americus, Ga.	

Steel Saddle Footprint Sketch

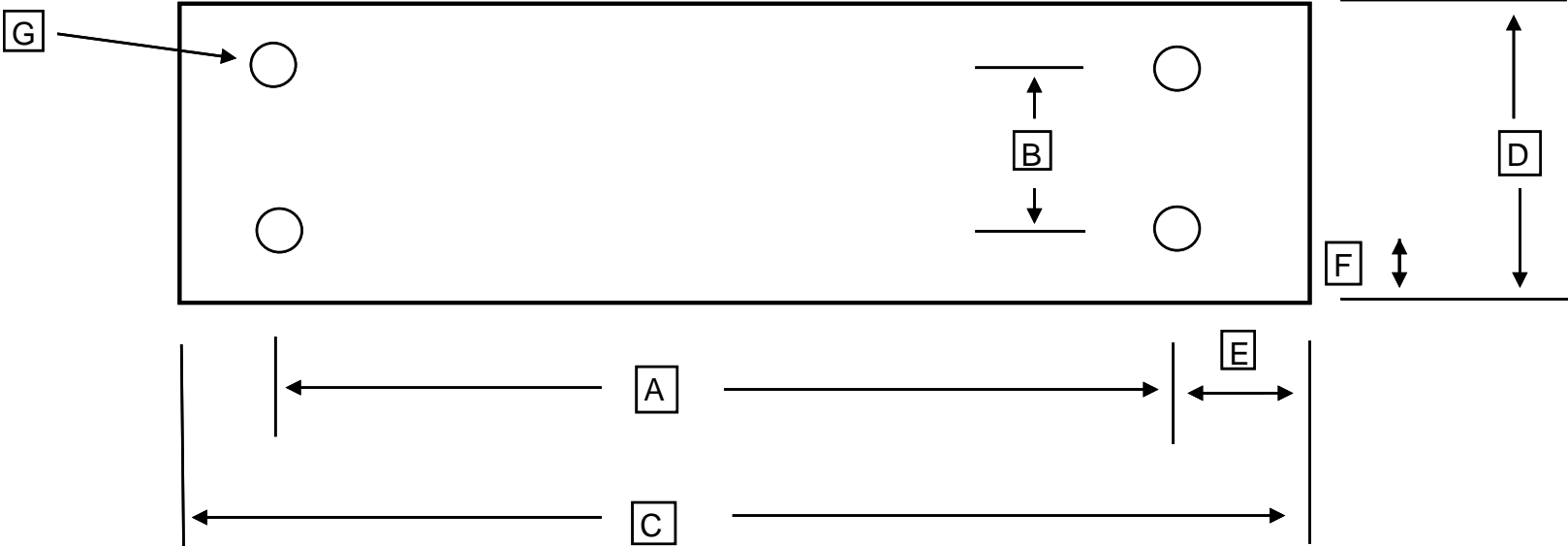

		Number of bolt holes	n/a
A		Center to center of bolt holes	n/a
B		Center to center of bolt holes	n/a
C		Outside plate dimension	n/a
D		Outside plate dimension	n/a
E		Center of hole to edge of plate	n/a
F		Center of hole to edge of plate	n/a
G		Bolt Hole Diameter	n/a
		Bottom of Foot Plate to Shell	n/a