

Manway Cover Detail

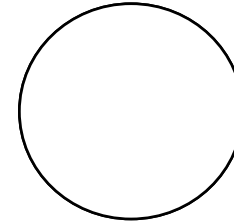

Outside Dia	25"
No of bolts:	16
Bolt length:	1.5"
Bolt dia.:	11/4"
Nom. size:	
Rating:	
Type:	21/4" thick

Inches from Head Seam

Code Plate

U-1 on hand Y/N
 Heat Treat Y/N
 X-Ray Y/N

Tank Openings

Tank Details

Description	Dimensions
O/A Length	A - 51'
Length - weld to weld	B - 40' 9"
Circumferanc	C - 32' 2"
Weld to End	D - 5'
Width of Piers	E - 10"
C/C of Piers	F - 34' 5"
C/L of Piers to Weld end	G - 39"
	H -
Radius Bumped Head 62 13/32"	

No Size Type

Description

1	2"	Liq	Flange		Manufacturer:	Horton Tank	Type of Head	Hemi
2	1 1/4"	Vap	threaded	manway	Date of manufacture	1958		
3	2"	Vap	threaded	manway			Tank Capacity	USWG 30,000
4	2"	Liq	threaded	manway	Working Pressure	250 @ 250	Tank Weight	estimated 62,300
5					National Board Number	3305	Tank Shell	
6					Serial Number	3560	Tank Head	.5"
7					Steel Type:			
8							Pier Type (Concrete / saddles / Flat)	Concrete
9					Jurisdiction #		Tank Saddles	Steel
10					Pressure Gauge	yes		
11					Liquid Level Gauge	ECII rotogauge		
12								
13					Paint Condition:	average		
14					Color:	white		
15							Information taken by:	Buddy Souto
16					Relief Valve Type	multiport	Date:	7/13/2009
17					Test Date		Tank Location	Americus, Ga

Steel Saddle Footprint Sketch

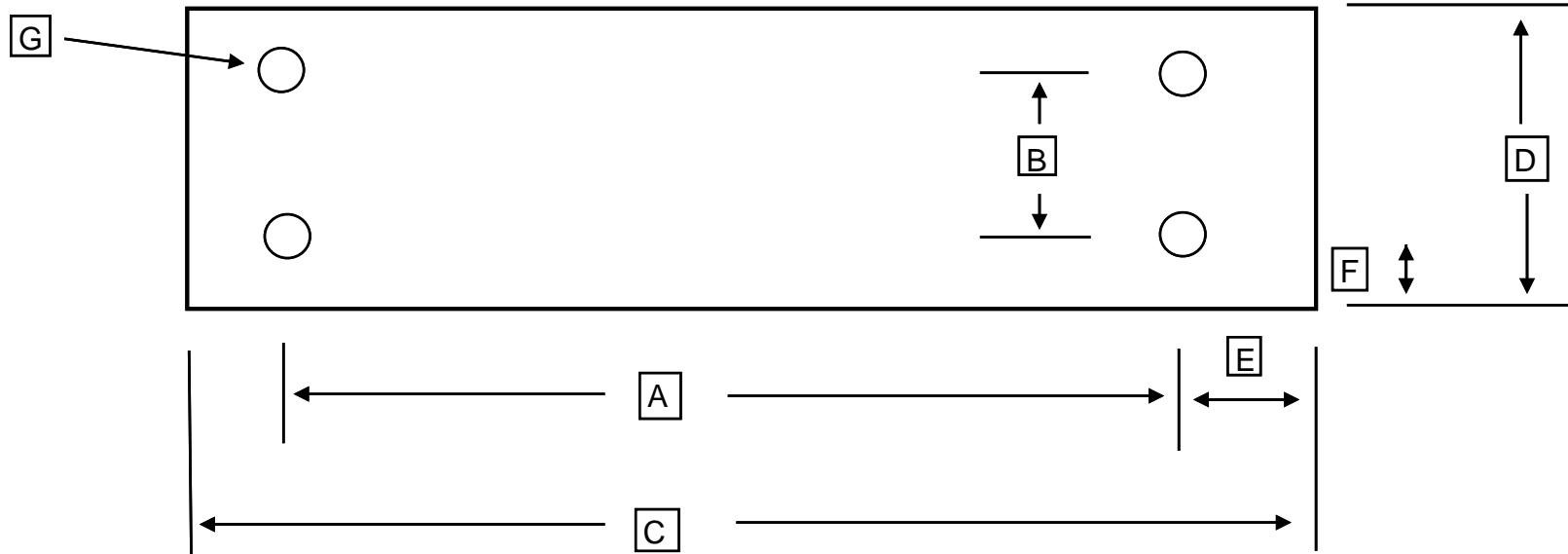

		Number of bolt holes	2
A	8' 9"	Center to center of bolt holes	n/a
B	N/A	Center to center of bolt holes	n/a
C	9' 51/4"	Outside plate dimension	n/a
D	12"	Outside plate dimension	n/a
E	4"	Center of hole to edge of plate	n/a
F	6"	Center of hole to edge of plate	n/a
G	1.5"	Bolt Hole Diameter	n/a
		Bottom of Foot Plate to Shell	n/a