

Manway Cover Detail

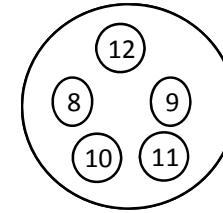

Outside Dia	25"
No of bolts:	16
Bolt length:	6-1/2"
Bolt dia.:	1-1/8"
Nom. size:	18"
Rating:	150#
Type:	Long Neck
Height of above shell:	14"

Inches from Head Seam

Inches - Flange face to shell

Tank Openings

U-1 on hand Yes
 Heat Treat Yes
 X-Ray Complete

Tank Details

Description	Dimensions
O/A Length	A - 47'
Length - weld to weld	B - 36' 4"
	O. D. C - 11'
Weld to End	D - 5' 4"
Width of Piers	E - 10"
C/C of Piers	F - 30' 0"
C/L of Piers to Weld end	G - 3' 2"
	H - 3' 2"

No	Size	Type	Description	Manufacturer: American Car & Fndry		Type of Head	Hemi	
1	3"	300#	9	10	Drain	Date of manufacture	1960	
2	3/4"	Sch 80			Thermowell in head	Working Pressure	250	
3	2-1/2"	WF			Magnatel mount in head	National Board Number	20668	
4	3/4"	NPT			Max. fill / pressure gauge in head	Serial Number	34-0676-5	
5	18"	150#	162	14	Manway	Steel Type:	SA-212 Grade B	
6								
7								
8	3"	300#			Blind	Jurisdiction #		
9	3"	300#			MultiPort mount	Pressure Gauge	0-300	
10	2"	Sch 80			Liquid	Liquid Level Gauge	Magnatel	
11	2"	Sch 80			Liquid			
12	2"	Sch 80			Vapor			
13						Paint Condition:	Fair	
14						Color:	Pale tan	
15						Information taken by:	GB/GF	
16						Relief Valve Type	MultiPort	
17						Test Date	2004	
						Date:	10/19/2009	
						Tank Location	#4 Middletown	

Steel Saddle Footprint Sketch

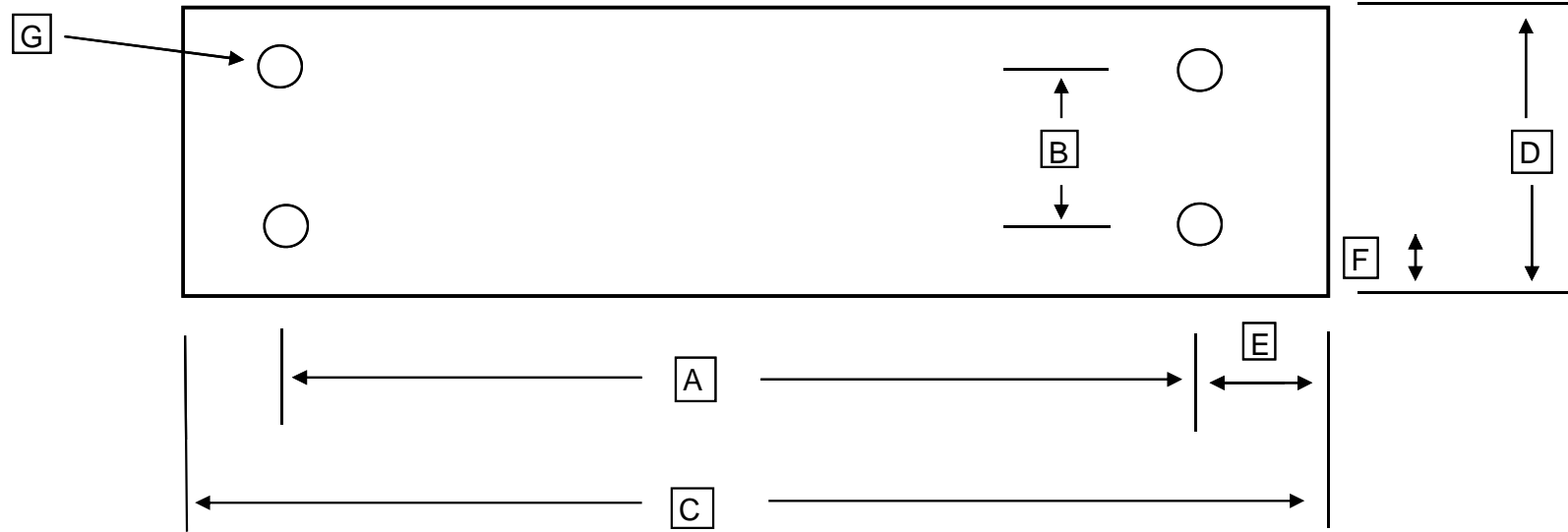

		Number of bolt holes	4
A		Center to center of bolt holes	8'
B		Center to center of bolt holes	5-1/2"
C		Outside plate dimension	9'
D		Outside plate dimension	10"
E		Center of hole to edge of plate	6-1/2"
F		Center of hole to edge of plate	2-1/4"
G		Bolt Hole Diameter	1"
		Bottom of Foot Plate to Shell	4-1/4"