

**Manway Cover Detail**

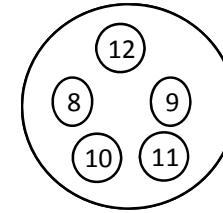

Outside Dia	25"
No of bolts:	16
Bolt length:	6-1/2"
Bolt dia.:	1-1/8"
Nom. size:	18"
Rating:	150#
Type:	Long Neck
Height of above shell:	14"

Inches from Head Seam

Inches - Flange face to shell

**Tank Openings**

U-1 on hand      Yes  
 Heat Treat      Yes  
 X-Ray              Complete

**Tank Details**

Description	Dimensions
O/A Length	A - 47'
Length - weld to weld	B - 36' 4"
	C - 11'
Weld to End	D - 5' 4"
Width of Piers	E - 10"
C/C of Piers	F - 30' 0"
C/L of Piers to Weld end	G - 3' 2"
	H - 3' 2"

No	Size	Type	Description	Manufacturer:	Dimensions			
1	3"	300#	9	10	Drain	American Car & Fndry	Type of Head	Hemi
2	3/4"	Sch 80			Thermowell in head		Date of manufacture	1960
3	2-1/2"	WF			Magnatel mount in head		Tank Capacity	USWG
4	3/4"	NPT			Max. fill / pressure gauge in head		Tank Weight	estimated
5	18"	150#	162	14	Manway		Tank Shell	15/16"
6							Tank Head	15/32"
7							Steel Type:	SA-212 Grade B
8	3"	300#			Blind		Pier Type (Concrete / saddles / Flat)	Flat
9	3"	300#			MultiPort mount		Tank Saddles	Welded Steel
10	2"	Sch 80			Liquid		Pressure Gauge	0-300
11	2"	Sch 80			Liquid		Liquid Level Gauge	Magnatel
12	2"	Sch 80			Vapor			
13							Paint Condition:	Fair
14							Color:	Pale tan
15							Information taken by:	GB/GF
16							Relief Valve Type	MultiPort
17							Test Date	2004
							Tank Location	#5 Middletown

Steel Saddle Footprint Sketch

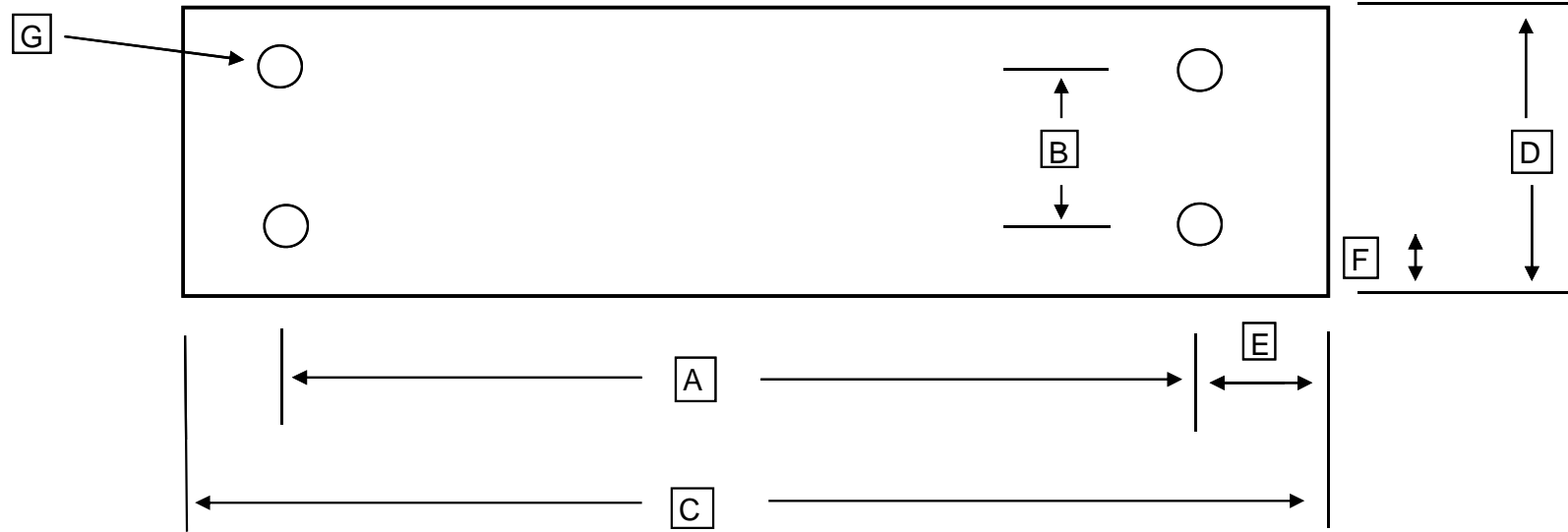

		Number of bolt holes	4
A		Center to center of bolt holes	8'
B		Center to center of bolt holes	5-1/2"
C		Outside plate dimension	9'
D		Outside plate dimension	10"
E		Center of hole to edge of plate	6-1/2"
F		Center of hole to edge of plate	2-1/4"
G		Bolt Hole Diameter	1"
		Bottom of Foot Plate to Shell	4-1/4"