

Total Energy Corp

Tank Sketch of field Information

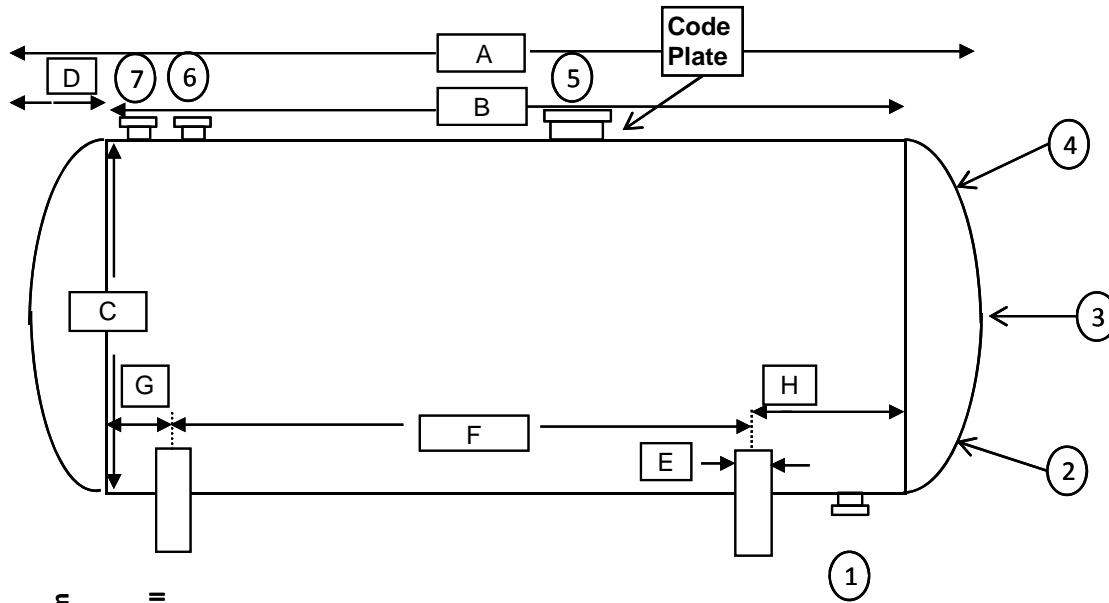

Manway Cover Detail

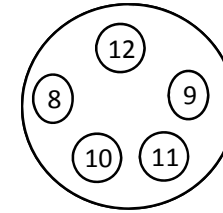

Outside Dia	25"
No of bolts:	16
Bolt length:	6-1/2"
Bolt dia.:	1-1/8"
Nom. size:	18"
Rating:	150#
Type:	Long Neck
Height of above shell:	14"

Inches from Head Seam

inches - Flange face to shell

Tank Openings

U-1 on hand Yes
 Heat Treat Yes
 X-Ray Complete

Tank Details

Description

Dimensions

O/A Length	A -	47'
Length - weld to weld	B -	36' 4"
	O. D. C -	11'
Weld to End	D -	5' 4"
Width of Piers	E -	10"
C/C of Piers	F -	30' 0"
C/L of Piers to Weld end	G -	3' 2"
	H -	3' 2"

No	Size	Type	Description		Tank Details			Dimensions	
1	3"	300#	9	10	Drain	Manufacturer:	American Car & Fndry	Type of Head	Hemi
2	3/4"	Sch 80			Thermowell in head	Date of manufacture	1966		
3	2-1/2"	WF			Magnatel mount in head			Tank Capacity	USWG
4	3/4"	NPT			Max. fill / pressure gauge in head	Working Pressure	250	Tank Weight	estimated
5	18"	150#	162	14	Manway	National Board Number	21245	Tank Shell	
6	4"	300#	24	10	MultiPort mount	Serial Number	44-62074-2	Tank Head	
7	4"	300#	12	10	Blind	Steel Type:	SA-212 Grade B		
8	2"	Sch 80			Vapor			Pier Type (Concrete / saddles / Flat)	Flat
9	2"	Sch 80			Vapor	Jurisdiction #		Tank Saddles	Welded Steel
10	2"	Sch 80			Liquid	Pressure Gauge	0-300		
11	2"	Sch 80			Liquid	Liquid Level Gauge	Magnatel		
12	1"	Sch 80			Plugged valve				
13						Paint Condition:	Fair		
14						Color:	Pale tan		
15								Information taken by:	GB/GF
16						Relief Valve Type	MultiPort	Date:	10/19/2009
17						Test Date	2004	Tank Location	#7 Middletown

Steel Saddle Footprint Sketch

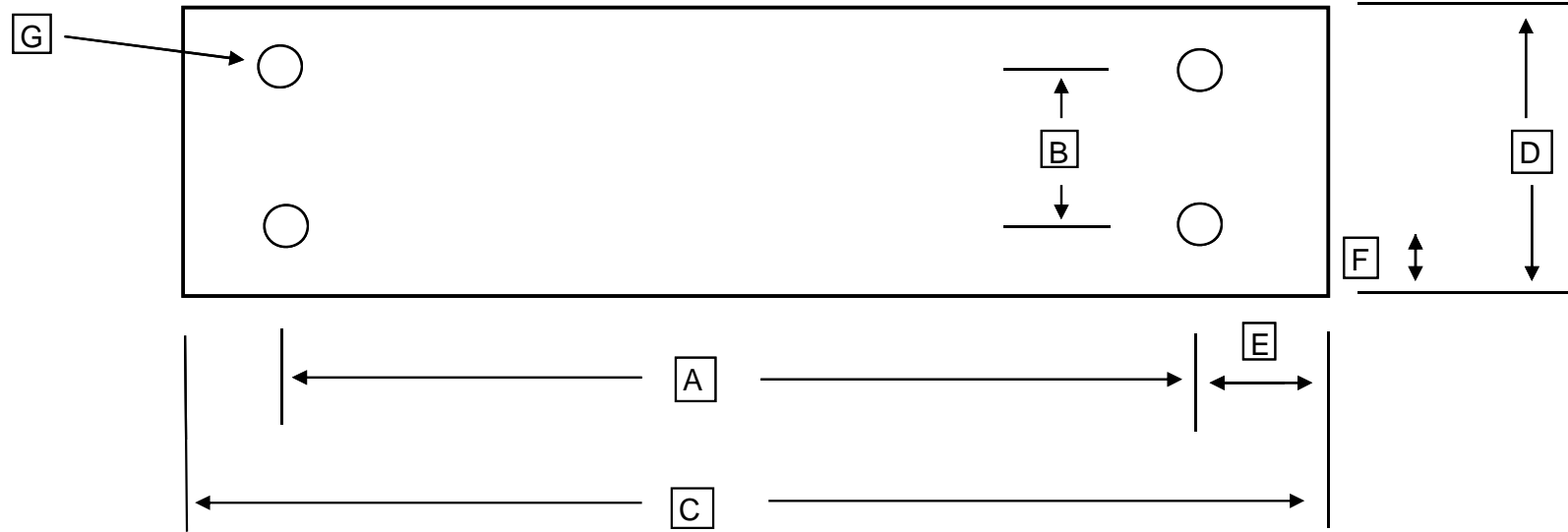

		Number of bolt holes	4
A		Center to center of bolt holes	8'
B		Center to center of bolt holes	5-1/2"
C		Outside plate dimension	9'
D		Outside plate dimension	10"
E		Center of hole to edge of plate	6-1/2"
F		Center of hole to edge of plate	2-1/4"
G		Bolt Hole Diameter	1"
		Bottom of Foot Plate to Shell	4-1/4"