

Manway Cover Detail

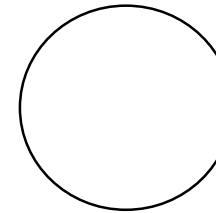

Outside Dia
 No of bolts:
 Bolt length:
 Bolt dia.:
 Nom. size:
 Rating:
 Type:
 Height of above shell:
 Distance from SW:
 Manifold Height above Shell:

	1	2
Outside Dia	36"	36"
No of bolts:	24	24
Bolt length:	10"	10"
Bolt dia.:	1.25"	1.25"
Nom. size:		
Rating:		
Type:		
Height of above shell:	16"	16"
Distance from SW:	2' 3"	10' 8"
Manifold Height above Shell:	35"	N/A

Inches from Head Seam

U-1 on hand Y/N
 Heat Treat Y/N
 X-Ray Y/N

Tank Openings

Tank Details

Description

Dimensions

O/A Length	A -	64' 3"
Length - weld to weld	B -	50' 3"
O. D.	C -	13' 3"
Weld to End	D -	7'
Width of Piers	E -	18"
C/C of Piers	F -	36'
C/L of Piers to Weld end	G -	7' 1 1/2"
	H -	7' 1 1/2"

No Size Type

Description

1	2"		2" Ball Valve	Manufacturer:	Chicago Bridge and	Type of Head	Hemi
2	2"		2" Ball Valve	Date of manufacture	1966		A516 Gr70
3						Tank Capacity	USWG
4				Working Pressure	300psig @ 650 deg	Tank Weight	estimated 58,500lb
5				National Board Number	3237	Tank Shell	
6				Serial Number	S-744	Tank Head	Concave
7				Steel Type:	A516 Gr 70		
8						Pier Type	(Concrete / saddles / Flat)
9				Jurisdiction #		Tank Saddles	Steel embedded in concrete
10				Pressure Gauge			
11				Liquid Level Gauge			
12							
13				Paint Condition:	Fair		
14				Color:	White		
15						Information taken by:	Coast to Coast USA NDE Services LLC
16				Relief Valve Type		Date:	
17				Test Date		Tank Location	

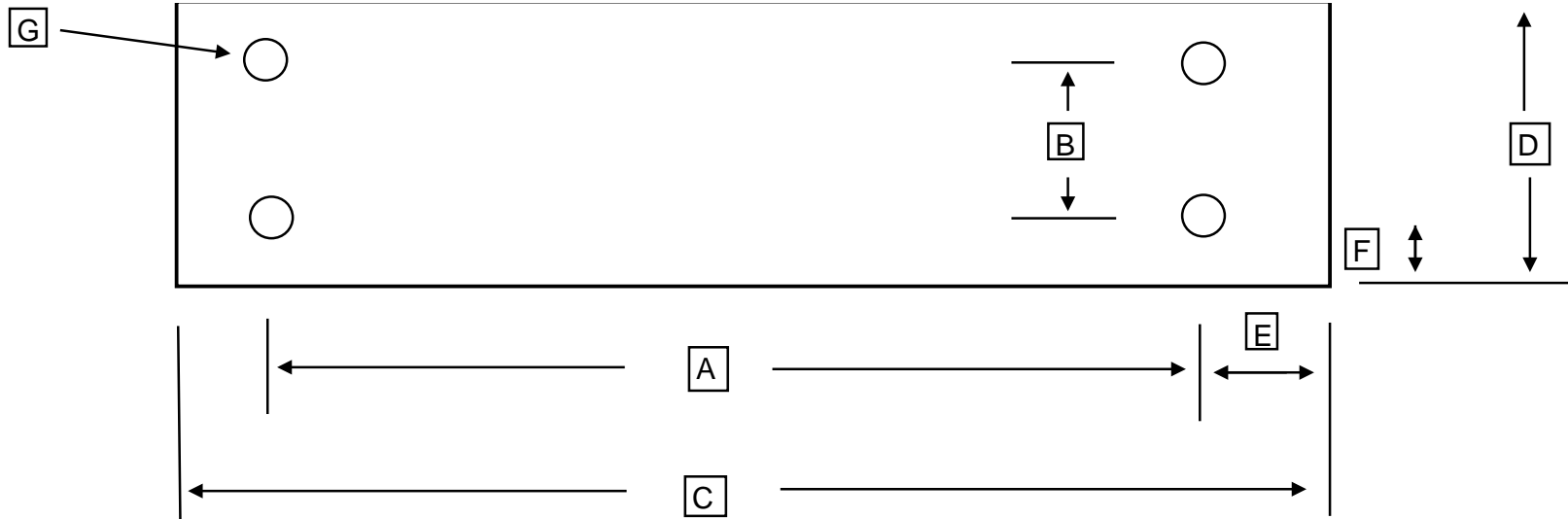

		Number of bolt holes	
A		Center to center of bolt holes	
B		Center to center of bolt holes	
C		Outside plate dimension	
D		Outside plate dimension	
E		Center of hole to edge of plate	
F		Center of hole to edge of plate	
G		Bolt Hole Diameter	
		Bottom of Foot Plate to Shell	