

**Manway Cover Detail**

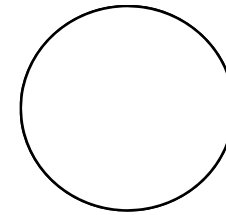

Outside Dia	25
No of bolts:	16
Bolt length:	7"
Bolt dia.:	1 1/8"
Nom. size:	18"
Rating:	
Type:	

Inches from Head Seam

U-1 on hand                      YES  
 Heat Treat                        NO  
 X-Ray

**Tank Openings**

**Tank Details**

Description		Dimensions	
O/A Length	A -		66"
Length - weld to weld	B -		62' 11"
	O. D.	C -	84"
Weld to End	D -		18"
Width of Piers	E -		14"
C/C of Piers	F -		54' 6"
C/L of Piers to Weld end	G -		32'
	H -		22'6"
	I -		57"
	J -		42"

No	Size	Type	Description	Tank Details	
1	6"	weld	IN MANWAY	Manufacturer:	Downington
2	3/4"	NPT	in head Plugged	Date of manufacture	1939
3	3/4"	NPT	in head Plugged		
4	3/4"	NPT	in head Plugged	Working Pressure	200
5	3/4"	NPT	in head Plugged	National Board Number	371
6	2"	NPT		Serial Number	1115
7	18"		Manway	Steel Type:	
8				Pier Type (Concrete / saddles / Flat)	
9				Tank Saddles	LOOSE STEEL
10				Pressure Gauge	
11				Liquid Level Gauge	
12					
13				Paint Condition:	Fair
14				Color:	White
15				Information taken by:	Ken Allen
16				Relief Valve Type	Date: 6/2/2009
17				Test Date	Tank Location: Syracuse, NY

Steel Saddle Footprint Sketch

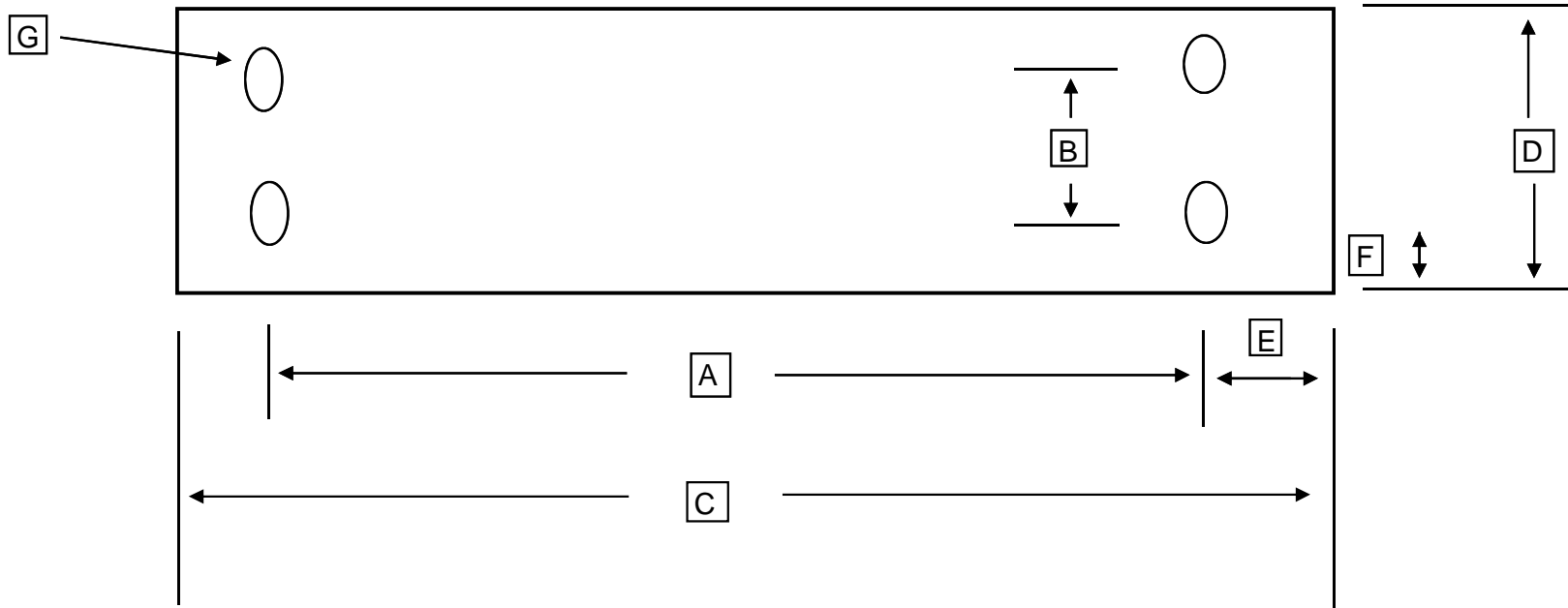

		Number of bolt holes	<b>4</b>
A		Center to center of bolt holes	<b>85"</b>
B		Center to center of bolt holes	<b>6"</b>
C		Outside plate dimension	<b>117"</b>
D		Outside plate dimension	<b>12"</b>
E		Center of hole to edge of plate	<b>16"</b>
F		Center of hole to edge of plate	<b>3"</b>
G		Bolt Hole Diameter	<b>3 1/2" x 1 3/8" Slot</b>
		Bottom of foot plate to shell	<b>5 1/2"</b>