

**Manway Cover Detail**

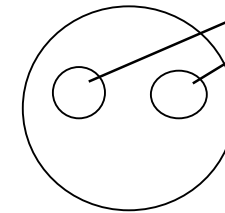

openings for multi ports

Outside Dia	23"
No of bolts:	16
Bolt length:	studs
Bolt dia.:	
Nom. size:	
Rating:	
Type:	
Height of above shell:	8"

8 " from shell to top of manway bolt

studs hold manway not bolts

This tank is numbered 9

**Tank Openings**

**Tank Details**

**Description**

**Dimensions**

O/A Length	A -	46' 8"
Length - weld to weld	B -	36' 1"
	C -	131.875
Weld to End	D -	5' 3 1/2 "
Width of Piers	E -	12"
C/C of Piers	F -	23' 4 3/4"
C/L of Piers to Weld end	G -	6' 3 1/8"
	H -	6' 3 1/8 "

U-1 on hand Y/N  
Heat Treat Y/N  
X-Ray Y/N

**No Size Type**

**Description**

1	3"	flanged	6	liquid	Manufacturer:	Riley Beard	Type of Head	Hemi
2	3"	flanged	24	liquid	Date of manufacture	1997		
3	2"	flanged	42	vapor			Tank Capacity	USWG 29,846
4	3/4"	threded		temp	Working Pressure	250	Tank Weight	estimated 51145
5	0.25"	threded		pres	National Board Number	50442	Tank Shell	0.8125
6	2.5"	threded		liquid level	Serial Number	218920-05-56	Tank Head	0.5
7	1"	threded		roto gauge	Steel Type:			
8							Pier Type (Concrete / saddles / FLAT)	Flat
9					Jurisdiction #		Tank Saddles	steel welded
10					Pressure Gauge	yes		
11					Liquid Level Gauge	yes		
12								
13					Paint Condition:	fair		
14					Color:	white		
15							Information taken by:	Phil
16					Relief Valve Type	n/a	Date:	7/23/2010
17					Test Date		Tank Location	mark west Pa

Steel Saddle Footprint Sketch

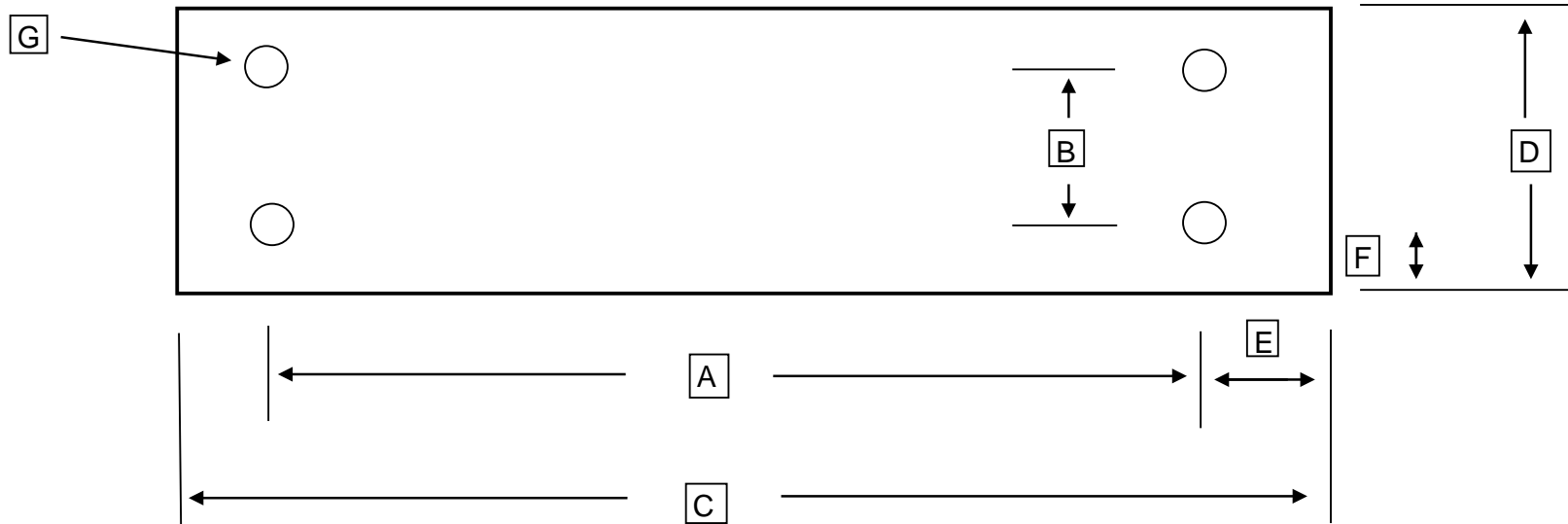

	Number of bolt holes	4
A	Center to center of bolt holes	84"
B	Center to center of bolt holes	6"
C	Outside plate dimension	116 5/8
D	Outside plate dimension	12"
E	Center of hole to edge of plate	16 5/8
F	Center of hole to edge of plate	3"
G	Bolt Hole Diameter	1 3/16"
	Bottom of Foot Plate to Shell	