

Manway Cover Detail

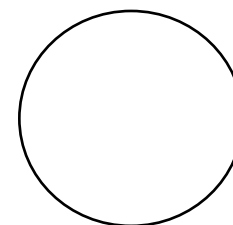

Outside Dia	
No of bolts:	14
Bolt length:	
Bolt dia.:	
Nom. size:	
Rating:	
Type:	

Code Plate

12
11
10
9
8
7
6
5
4
3
2
1

Tank Openings

Tank Details

Description

Dimensions

O/A Length	A -	47'2-1/8"
Length - weld to weld	B -	
Weld to End	C -	11'
Width of Piers	D -	
C/C of Piers	E -	
C/L of Piers to Weld end	F -	24' 7-1/4"
	G -	
	H -	

U-1 on hand
Heat Treat
X-Ray
YES
YES
Complete

No Size Type

Description

1	2"	NPT	12 1/4"	Vapor	Manufacturer:	Trinity	Type of Head	Hemi
2	3"	NPT	13"	Liquid	Date of manufacture	1969		
3	2"	NPT	25 1/4"	Vapor			Tank Capacity	USWG
4	2"	NPT	37 1/4"	Vapor	Working Pressure	250	Tank Weight	estimated
5	1/2"	NPT	in head	Thermowell	National Board Number	34476	Tank Shell	
6	2-1/2"	NPT	in head	Magnatel mount	Serial Number	365360	Tank Head	
7	1/4"	NPT	in head	Plugged	Steel Type:	SA515-70		
8	1/2"	NPT	in head	Max-Fill / Pressure Gauge			Pier Type (Concrete / saddles / Flat)	
9	2"	NPT		Pressure Relief	Jurisdiction #		Tank Saddles	Welded Steel
10	2"	NPT		Pressure Relief	Pressure Gauge			
11	2"	NPT		Pressure Relief	Liquid Level Gauge	Magnatel		
12	18"			Manway				
13					Paint Condition:	Good		
14					Color:	White		
15							Information taken by:	Frank Kovacs
16					Relief Valve Type	Internal	Date:	6/4/2009
17					Test Date		Tank Location	KIK-Cumberland, RI

Steel Saddle Footprint Sketch

Front Saddle (business end)

Closed End

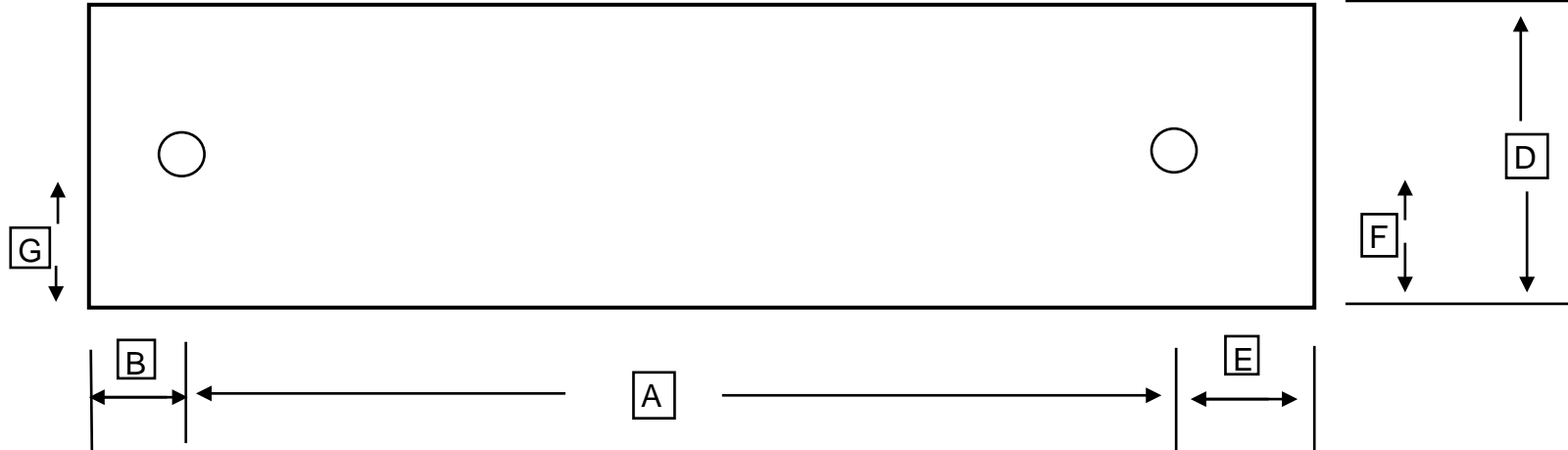

	Number of bolt holes	2
A	Center to center of bolt holes	5-3/4"
B	Center of hole to edge of plate-Left	9-7/8"
C	Outside plate dimension	115-3/4"
D	Outside plate dimension	12"
E	Center of hole to edge of plate Right	10-1/8"
F*	Center of hole to edge of plate-Right	6-1/2"
G*	Center of hole to edge of plate-Left	5-3/4"
	Bolt Hole Diameter	
	Bottom of Foot Plate to Shell	

* Measurements are from the inside of saddle. Outside of saddle is closed.

